

## Anthology Deptford Foundry

Complete

Area

Client

Architect

2020

UK England

Anthology

Rolfe Judd Architecture /  
Associated Architects

Anthology London's Deptford Foundry pays homage to a former 1831 metal foundry on Arklow Road, once a thriving producer of a variety of metal goods. The residential development is uniquely positioned on a three-acre site between two converging railways and consists of 316 new build residential properties, as well as commercial space with creative studios.

Each home sits within one of nine buildings, ranging from 6 to 22 storeys. The £70million regeneration of the former industrial estate also includes 32,000 sq. ft. of studio and arts spaces ensconced in a communal landscaped garden, giving the area a creative flair.



© Julian Franklin Photography

### Special acoustic features

Given the proximity of the railways, extensive noise and vibration survey works were complemented with detailed noise mapping of the site and surrounding area. The results were used to determine performance requirements of the external envelope.

Thorough analyses of external noise profiles were used to advise the team on the implications of using open windows to manage thermal comfort, in accordance with the planning requirements for the scheme.

Sandy Brown provided an audio demonstration of potential vibration-induced noise to assist the Client in determining their expectations for the scheme.

The results of the demonstration were used in conjunction with extensive site survey works to establish an appropriate scheme of mitigation against ground borne vibration.

In addition, very high levels of internal sound insulation were provided to protect future residents from noise associated with adjacent commercial uses.

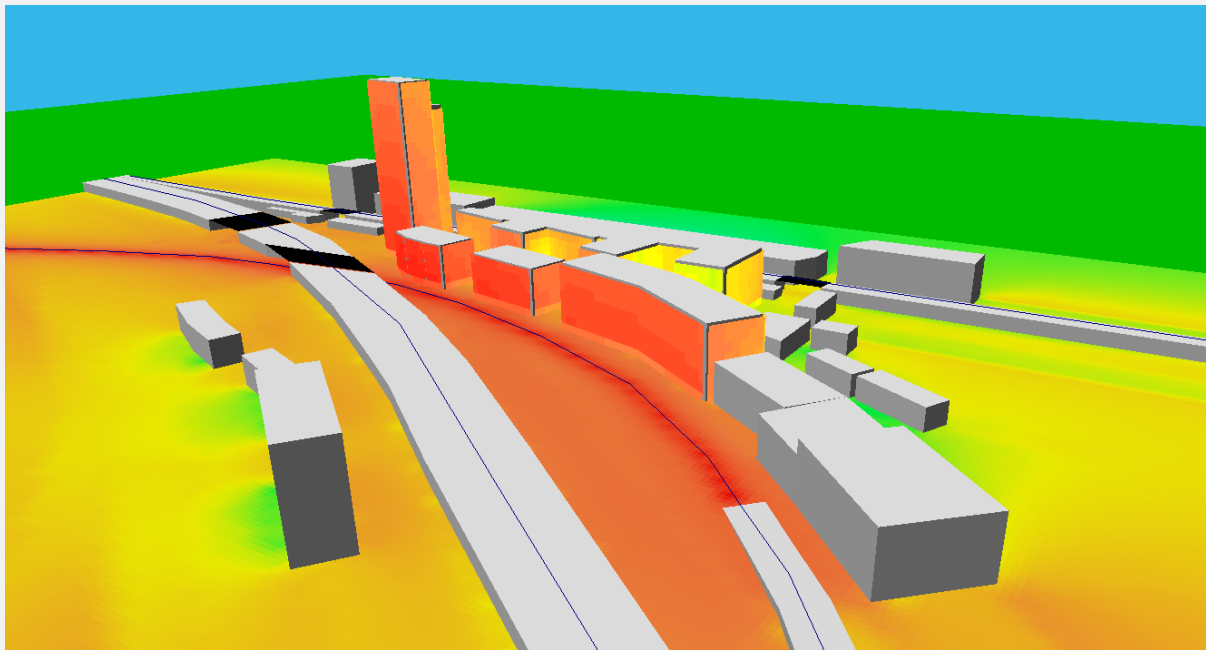

© Sandy Brown Associates LLP